

The Bass & Irvine Addition to McPherson Kansas is located in the following described tract of land. Beginning at a stone situated on 1/4 sec line 300 feet East of the center of Sec 28 T19 Range 3 West of the 6th P.M. Thence East on a 1/4 sec line 1349.5 feet to a stone. Thence North 72.0 feet. Thence East 601.3 feet. Thence South 72.0 feet to a stone situated on 1/4 sec line. Thence East 395 feet to the 1/4 sec corner between Sec 27 and 28. Thence North on Sec line 1315 ft to the 1/4 sec Cor. Thence West on the 1/4 sec line 1876 feet to a stone. Thence South 528.5 ft to a stone. Thence West 400.5 ft. Thence South 790 ft to the place of beginning. The same being a part of the South 1/2 of the North East 1/4 of Sec 28 T19 Range 3 West of P.M. and is divided into blocks lots streets and alleys as shown by the foregoing plat. That portion of land indicated on Plat as Cottinghams Reserve is not included in this Addition. I hereby certify that the foregoing Plat & Notes are correct and conform strictly with the Survey made by me on the 25th day of March A.D. 1887

I, A. Bass, Notary Public, do hereby certify that the foregoing Plat & Notes are correct and conform strictly with the Survey made by me on the 25th day of March A.D. 1887.

I know all men by their names that the Keystone Investment Company, a corporation duly organized under and doing business under the laws of the State of Kansas is the owner of the tract of land upon which Bass & Irvine Addition to McPherson, Kansas is located, as shown by the foregoing plat and notes, and that the disposition of the same is in accordance with the designs and instructions of the Board of Directors of said Company. In witness whereof the Keystone Investment Company has caused these presents to be signed by its President and attested by its Secretary this 25th day of March A.D. 1887.

Attest  
R.M. Daniel  
Secretary

The Keystone Investment Company  
By M. L. Striving  
President

State of Kansas, }  
McPherson, Co., }

I, Be it remembered, That on this 25th day of March A.D. 1887, before me the undersigned, a Notary Public in and for the County and State aforesaid, came M. L. Striving, President of the Keystone Investment Company who is personally known to me to be the same person who executed the within instrument of writing, and such person has duly acknowledged the execution of the same as the Act and Aid of said Company.

In witness whereof, I have hereunto set my hand and affixed my official Seal, this day and year last above mentioned.

A. Bass  
Notary Public.

Com. Expires Sep 7th 1890.

# BASS & IRVIN

## ADDITION

TO

### McPHERSON KANSAS.

28<sup>th</sup> me  
7<sup>th</sup> 3<sup>rd</sup> P  
Plats  
to Addition  
Key. Deeds

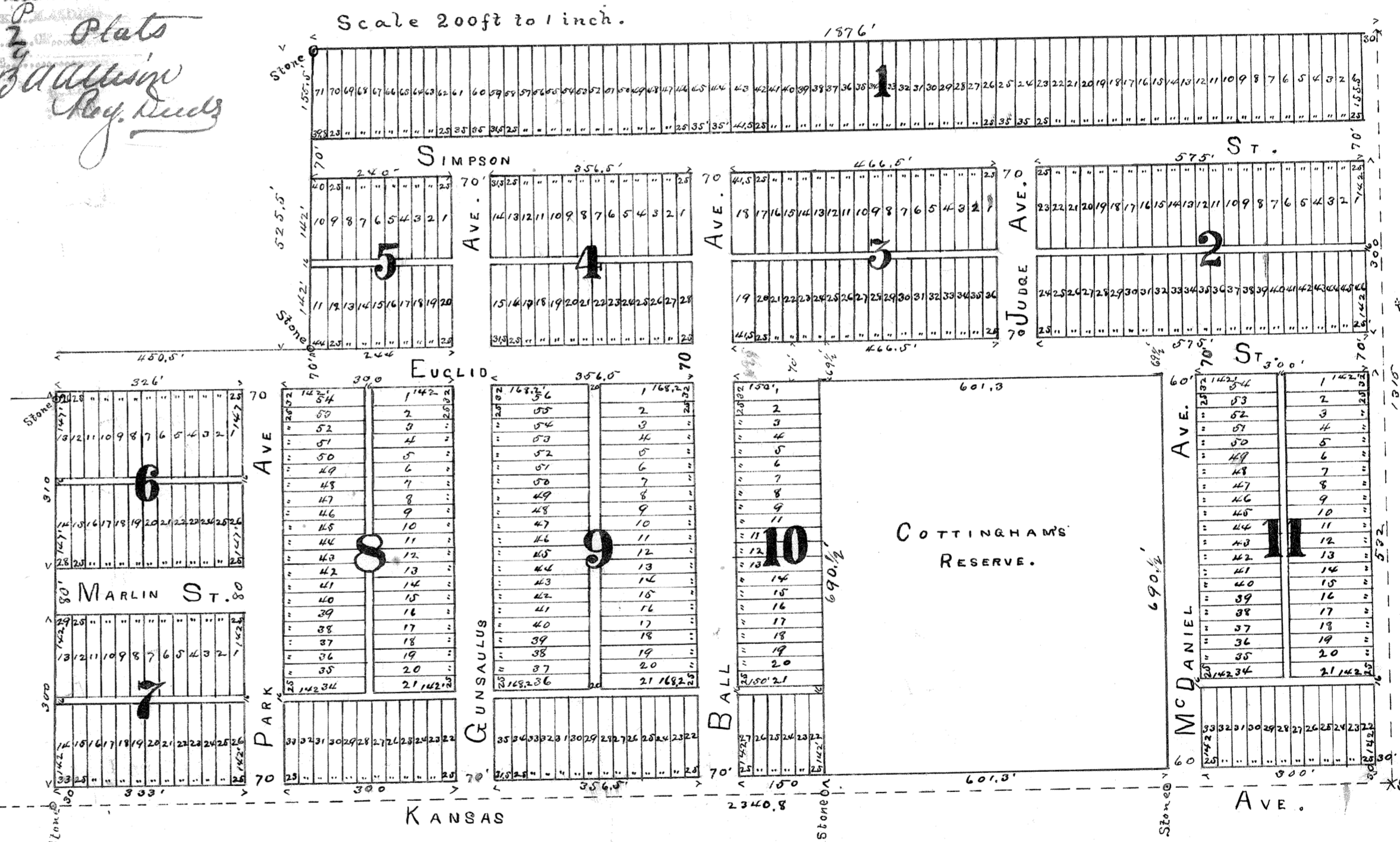

STATE OF KANSAS  
McPherson County,  
Entered on Transfer Record in my  
Mch 28, 1887  
O. L. Loomis  
COUNTY CLERK

F.C. Cole C.E.