

HALE'S SUBDIVISION

OF THE SOUTH HALF OF BLOCK FOUR (4) OF FOUTS FIRST ADDITION TO McPHERSON KANS.

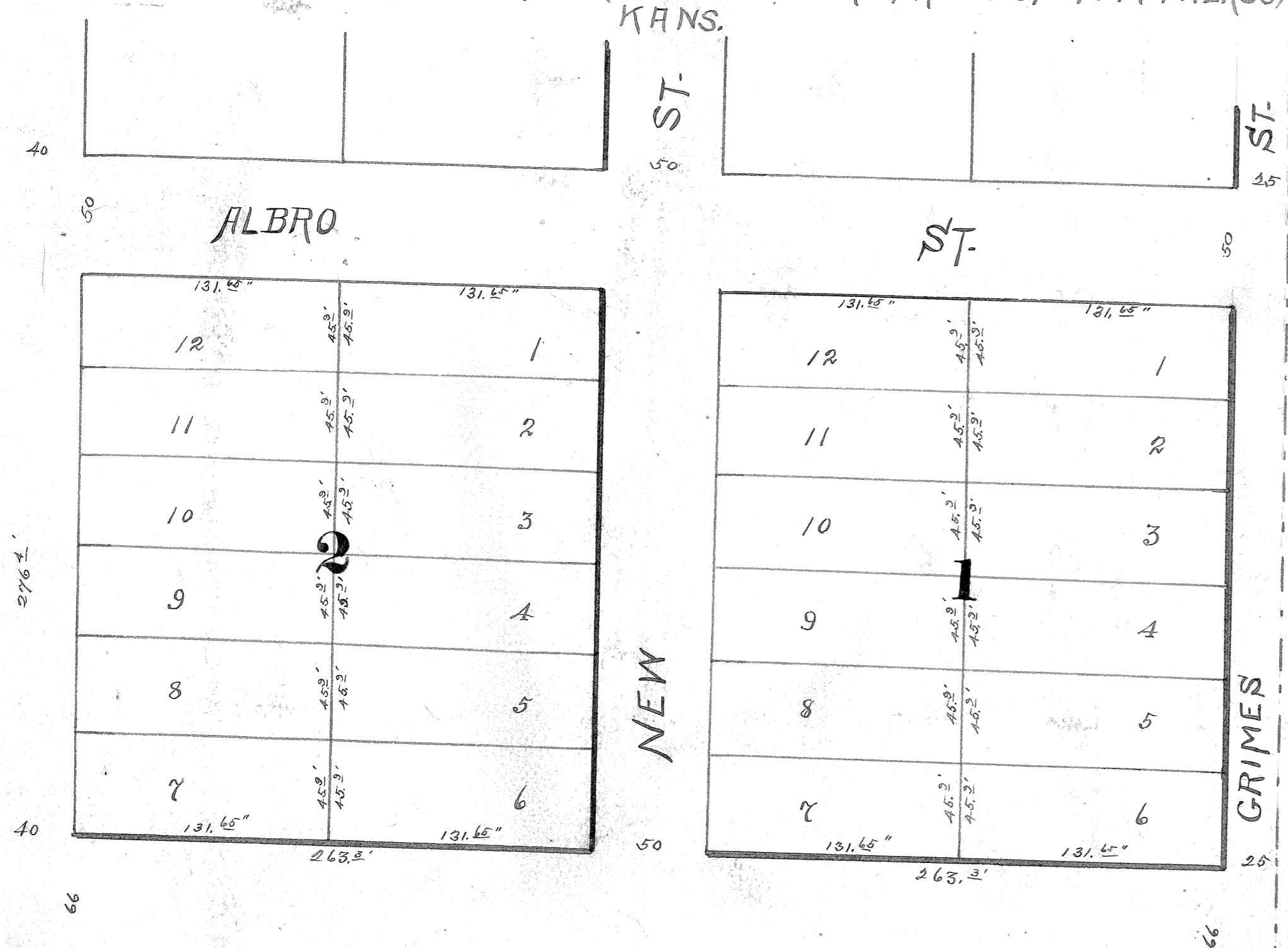

Hale's Subdivision of the south half of Block Four (4) of Fouts First Addition to the city of McPherson Kansas is located on the south half of Block Four (4) of Fouts First Addition to the city of McPherson Kansas, and a strip of land Twenty five (25) feet wide off the west end of lots 9-10-11-12-13-14 & 15 of Block Five (5) Freeman's Addition to the city of McPherson, Kansas, and is divided into blocks, lots & streets as shown by this plat. All lots are Forty five and nine tenths (45.9) feet wide and One hundred thirty one and eighty five hundredths (131.45) feet long.

I hereby certify that the foregoing plat and notes of Hale's Subdivision of the south half of Block Four (4) of Fouts First Addition, conforms strictly to the survey made by me on the 17th day of February, A.D. 1887.

A. Bass, Surveyor

This is to certify that George D. Hale and Frank C. Hale (his wife) being the owners of the following described property situated in McPherson County, State of Kansas, to wit: The south half of Block Four (4) of Fouts First Addition to the city of McPherson, Kansas, and a strip of land Twenty five (25) feet wide off the west end of lots 9-10-11-12-13-14 & 15 of Block Five (5) Freeman's Addition to the city of McPherson, Kansas (which said parts of lots are set aside as streets) have caused to be made out an accurate plat of said premises, and subdivision, to be known and designated as Hale's Subdivision, which said plat with the statement and certificate of A. Bass, surveyor, written thereon, and being a part of such plat particularly sets forth and describes all the grounds within said subdivision, received for public purposes by the boundary line courses and extent thereof, and whether the same is intended for avenues, streets, lanes, alleys, commons or other public uses, and also particularly sets forth and describes all lots intended for sale, by number and blocks, and the precise length and width of each of said lots, which said plat is the same plat upon which this certificate is indorsed.

In witness whereof, the said George D. Hale, and Frank C. Hale have hereunto set their hands and affixed their seals, this day of February, 1887.

George D. Hale.
Frank C. Hale.

State of Kansas }
Shawnee County } ss. Be it remembered that on this 13th day of Feb. A.D. 1887 before me the undersigned, a Notary Public within and for the County and State aforesaid personally appeared George D. Hale and Frank C. Hale who are personally known to me to be the same persons who executed the foregoing instrument of writing, and such persons duly acknowledged the execution of the same.

In testimony whereof, I have hereunto set my hand, and affixed my Notarial Seal this day and year last above written.

commission expires Feb 18th-1890. F. N. Barry,
Notary Public Shawnee County Kansas

State of Kansas }
McPherson County } ss. a true copy of original as filed July 21-1887 at 11:40 A.M.

B. M. ...

For vacation of Albro Street see Misc 70 page 148.