

Map of Hamilton I L T O

HAMILTON I L T O

SUB-DIV. OF BLOCK 8. BREWER'S SUB-DIV.

S

McPHERSON,

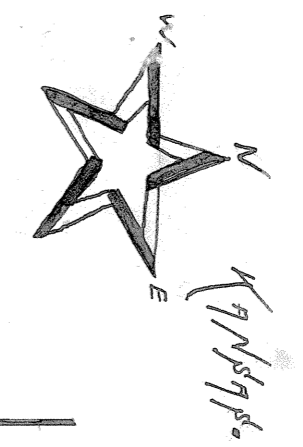

SCALE 50 FT = 1 INCH

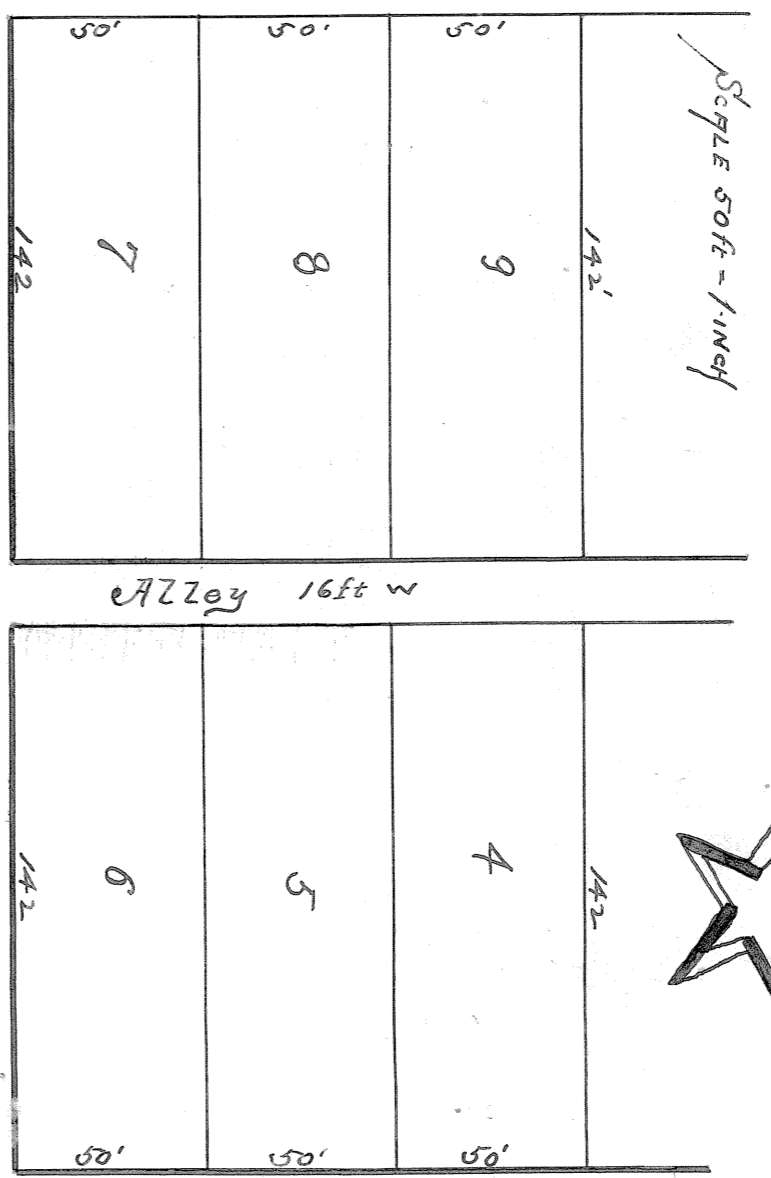

WOODSIDE ST

Hamilton's Sub-division is a sub-division of the South
 half of Block Eight (8) of Brewer's Sub-division, McPherson,
 Kansas. All lots are 50 feet by 142 feet, and an alley
 16 feet wide, shown in accordance with an accurate survey
 made this 24th day of May A.D. 1857.

Shown all men by their parents that ^{supervisor} C. P. Hamilton
 was the present owner of the above described of land and the
 same has been laid out for town purposes as shown on the
 above plat in accordance with my designs and instructions
 given my said title 1st day of June 1857.

C. P. Hamilton

State of Kansas }
County of McPherson } 5th

Personally appeared before me, ^{Notary Public} C. P. Hamilton
 said County and State C. P. Hamilton who by
 personally known to me to be the identical person who
 executed the above certificate and duly acknowledged
 the same to be his act and deed for the purpose therein
 set forth.

At Testimony whereof I have set my hand and affixed my
 Notarial seal this 1st day of June 1857.

My Commission expires ^{24th day of June} 31st day of June 1857.
 Notary Public

NOTARY PUBLIC,
 STATE OF KANSAS,
 THIS INSTRUMENT FILED FOR
 RECORD ON THE 2nd day of June
 1857, at 2 o'clock P.M. and
 recorded in book 57, page 31.
 J. P. McClelland, Clerk