

# HANSON'S ADDITION

to MARGUERITE

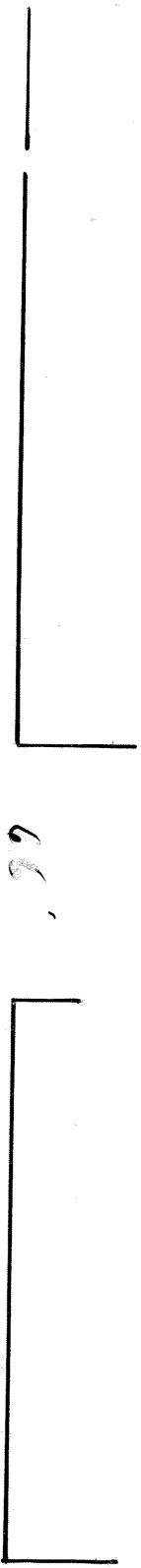

5<sup>th</sup>

ST

66'

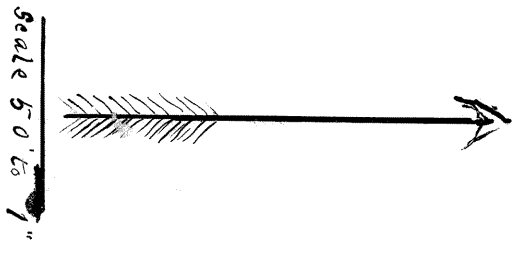
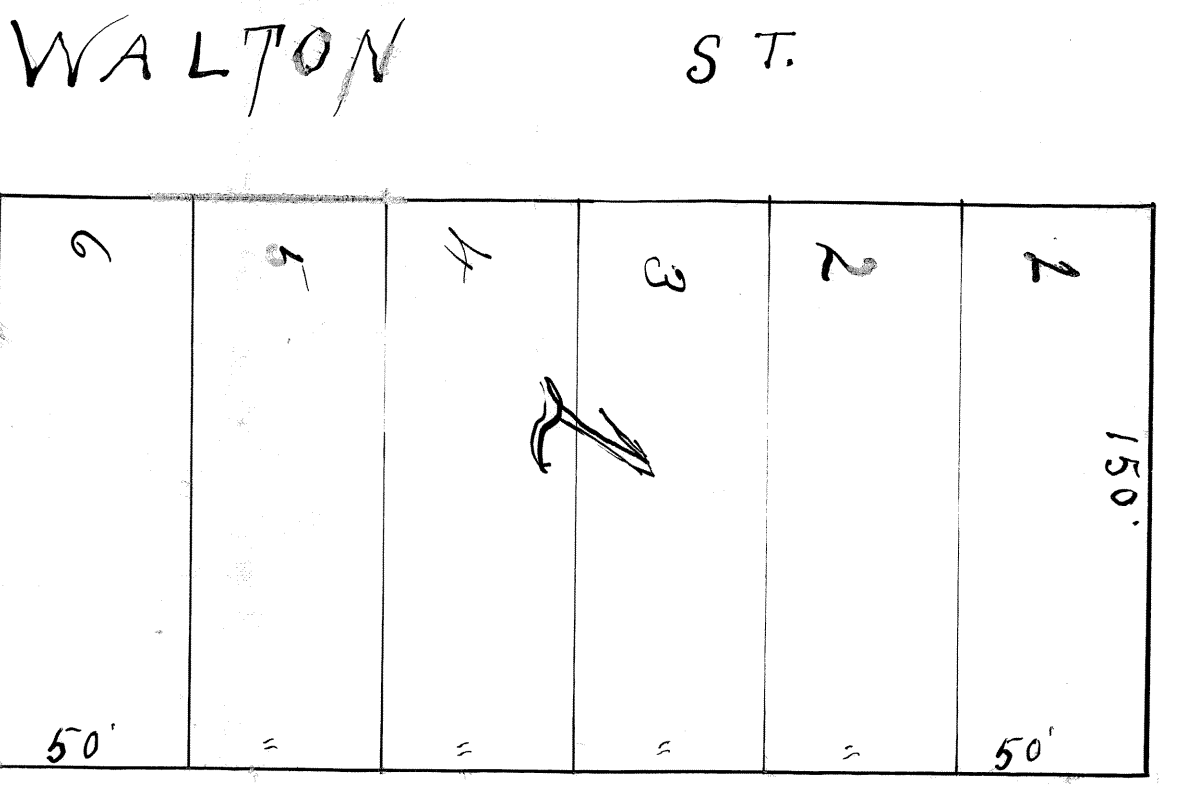
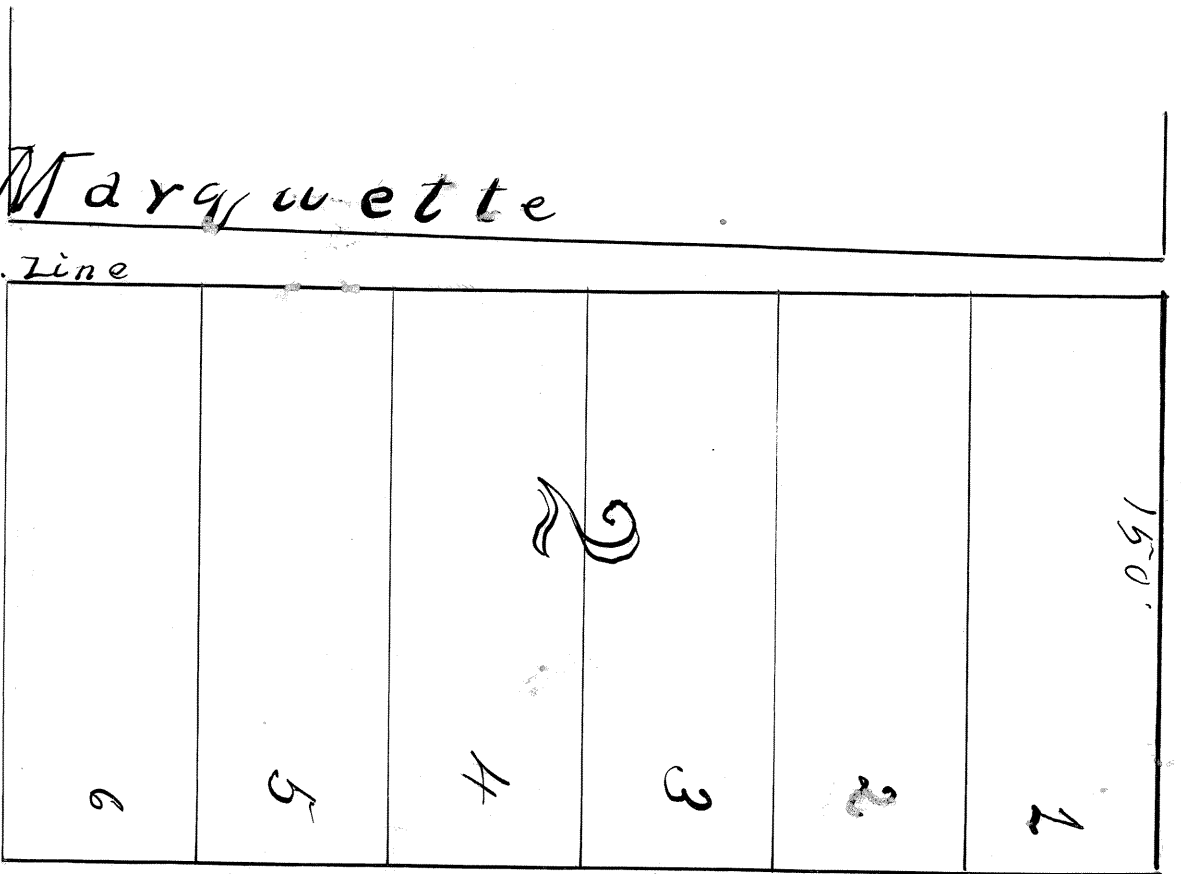

THIS INSTRUMENT WAS FILED FOR RECORD IN THE PUBLIC RECORDS OF THE COUNTY OF KANSAS, ON the 20th day of June 1887, at 10 o'clock A.M. in Book 32, page 32. J. H. Williams, Register.

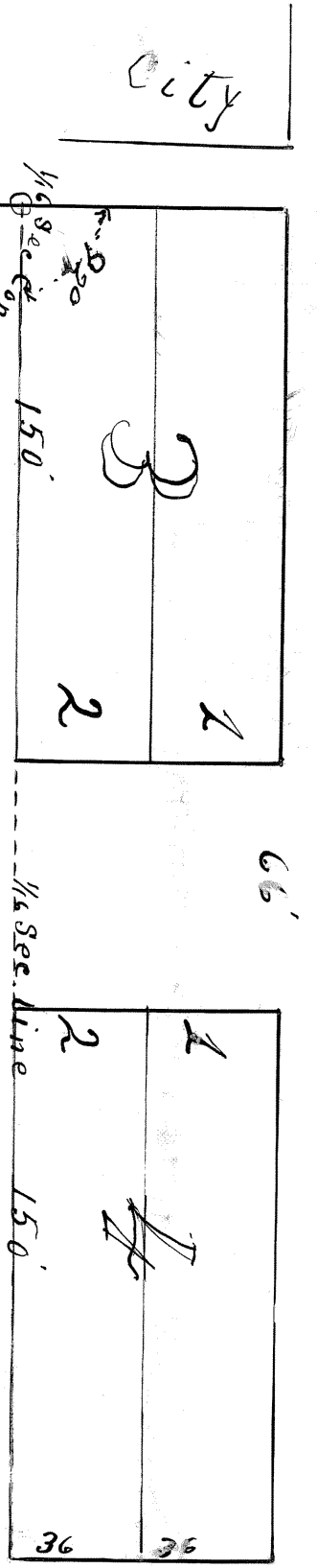

Fair View add.

June 20, 1887  
G. L. Williams  
Register

Hanson's Addition to Marguerite as shown by the foregoing plat is located in the South West corner of the North West Quarter (1/4) of the South West Quarter (1/4) of Section Twenty Four (24) Town Seventeen (17) Range Five (5) West of the 6th P.M. and is described as follows: Beginning at the Sixteenth (1/16) Corner at the South West Corner of the North West Quarter (1/4) of said South West Quarter (1/4). Thence East one Sixteenth (1/16) Section line 366 feet. Thence South one Section line 504 feet to the place of beginning, and is divided into Blocks, Lots and Streets as shown by above plat. All Lots are 50 feet by 150 feet except Lots in Blocks 3 and 4 which are 36 feet by 150 feet. All Streets are 66 feet wide. Surveyed June 18th 1887

A. H. Bell, Surveyor  
I now all men by these presents that G. Hans Hanson and the present owner of the land shown which Hanson's Addition to Marguerite is situated as shown by the foregoing plat and notes, and that the acquisition of the same is in accordance with my design and instruction. Witness my hand this 20th day of June 1887

State of Kansas } ss.  
County of Marion }  
I, J. H. Williams, County Clerk, do hereby certify that on this 20th day of June 1887 before me the undersigned, a Notary Public in and for the county and State aforesaid, personally appeared Hans Hanson who is personally known to me to be the same person who executed the foregoing instrument of writing and duly acknowledged the execution of the same. Also testifying whereof I have hereunto set my hand and official seal this 20th day of June 1887.

A. B. Beck, Notary Public  
Commission expires Sept. 14th 1890