

IRWIN'S

SUB-DIVISION OF LOTS 1, 2, & 3 OF BLOCK 77

IN
McPHERSON, KANSAS.

Scale 25 ft. to the inch

80'

100'
KANSAS

Ave.

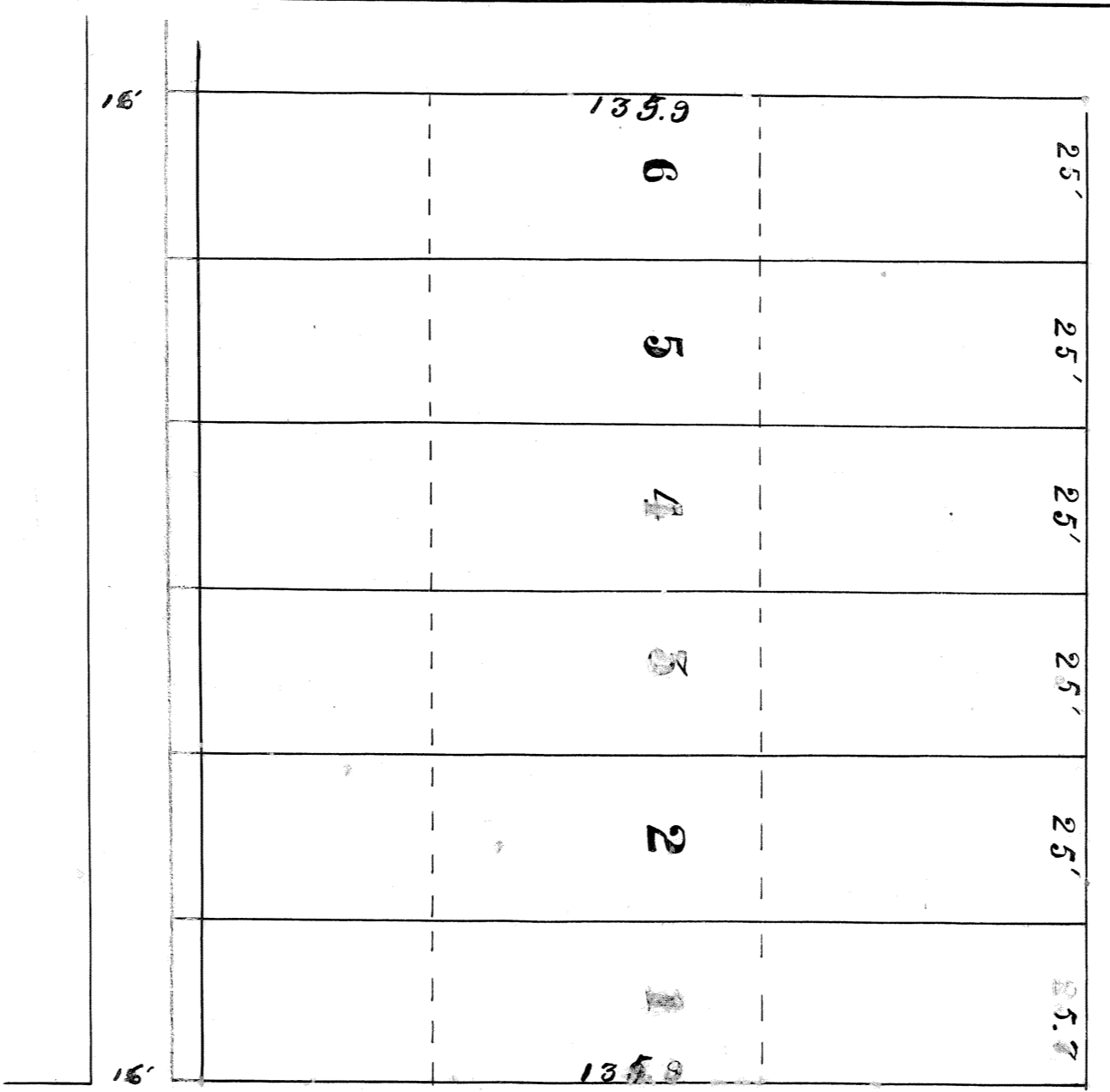
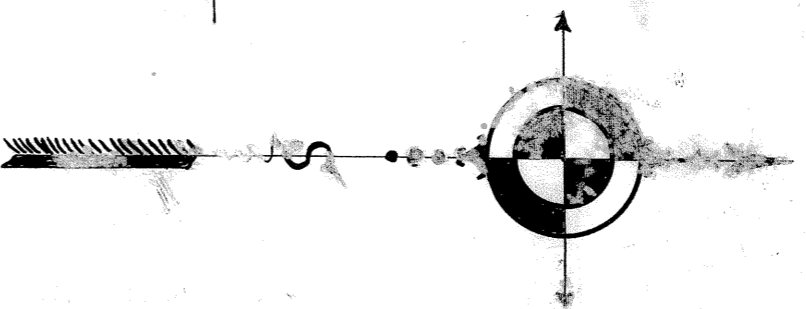

80'

City

Irwin's Sub-Division of Lots 1, 2 and 3 of Block 77 of the city of McPherson, Kansas, situated in the City of McPherson, Kansas, as shown on the original plan of the above mentioned lots and an alley as shown by the foregoing plat. All lots are 25' wide except lot 1 which is 25.7' wide, and all lots are 135.9' long. I hereby certify that the foregoing plat and notes are correct, and in every way conforms to a survey made by me on Tuesday of February, A. D. 1887.

D. C. Irwin

Know all men by these presents that J. A. Irwin, the present owner of lots 1, 2 and 3, Block 77, upon which land Irwin's Sub-Division as described above is situated, and do hereby certify that the disposition of the land is in accordance with my design and instruction.

State of Kansas }
McPherson Co. }
Be it remembered on this 26 day of April, A. D. 1887, before me a Notary Public in and for the County and State aforesaid, personally appeared A. D. Irwin, who is personally known to me to be the same person who executed the foregoing instrument of writing and such person duly acknowledge the same in testimony whereof I have hereunto set my hand and affixed my Notarial Seal this day and year last above mentioned.

A. B. Wells

Commission Expires Sept. 27, 1890 Notary Public

28 and 29 records # 2
1887, 9. Recd 14
J. A. Irwin

STATE OF KANSAS }
McPherson County }
Recorded on Transfer Record in my
office
April 28, 1887
C. H. Williams
COUNTY CLERK.