

WRIGHT & OLSON'S ADDITION

MEPHERSON

KANS.

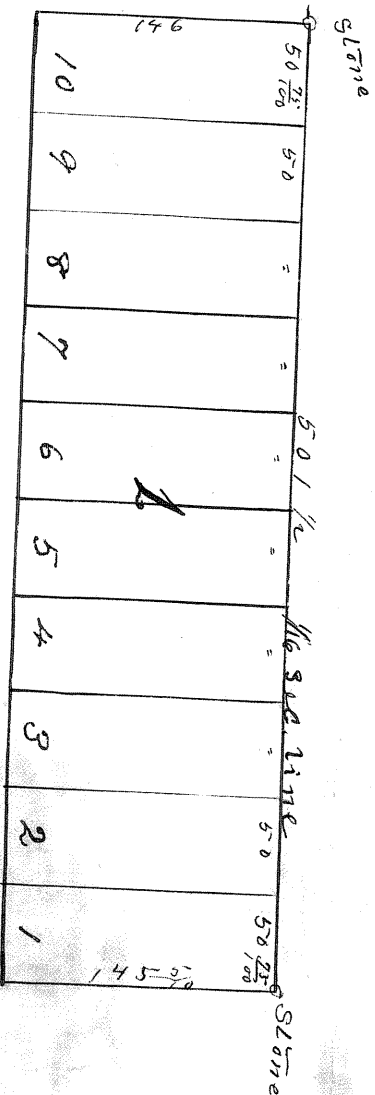

80 Simpson

ST

80

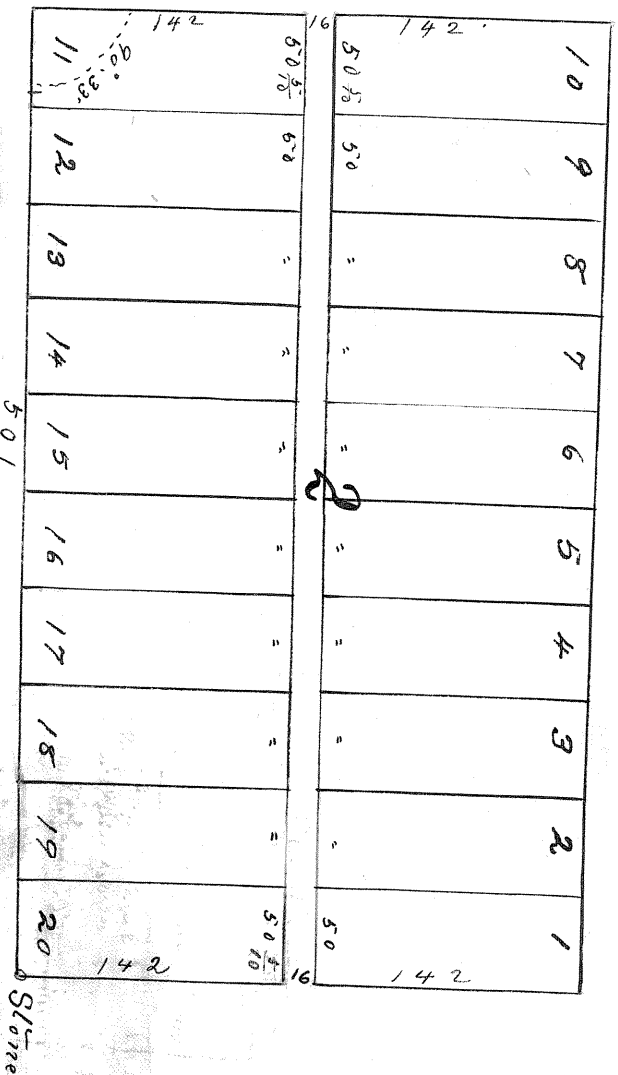

Wright & Olson Addition to MePherson Town, is located on a part of the South West quarter of the North East quarter of Sec. 28-9-19-R. 3 N. & 4 PM. and lies directly East of Regnell's Addition to MePherson Town. Simpson Street connects north and is a continuation of the street bearing the same name in Regnell's Addition. And is divided into lots & blocks & streets and alleys as shown by above plat.

A. B. Ball Surveyor.

Shew all men by these presents that N. S. Olson and the owner of the land upon which Wright & Olson addition to MePherson town is located as shown by the foregoing plat and Note & do hereby certify that the disposition of the land is in accordance with my design and intention

N. S. Olson

State of Kansas } Do it remembered on this 24th day of  
 MePherson County } January A.D. 1887 before me a Notary Public  
 in and for the county of MePherson and State of Kansas personally  
 appeared A. T. Olson who is personally known  
 to me to be the same person who executed the foregoing  
 instrument of writing and next person duly acknowledged  
 the same  
 In testimony whereof I have hereunto set my hand and  
 official my notarial seal the day and year last above  
 written

A. B. Ball

Commission expires Sep. 9th 1890

Notary Public

See Returns # 183  
 Records M-255/244

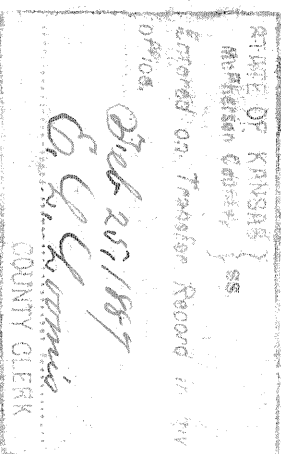

425 Feb 1887  
 at MePherson  
 MePherson Kan.  
 of State  
 of page 7  
 MePherson  
 G. V. G. MePherson